

C-AS Weld Fitting

Weld Connection /
24° Tube Connection (DIN EN ISO 8434-1)

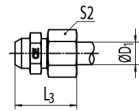

C-WAS

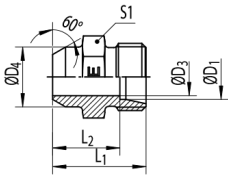

Series	PN [bar]		ØD ₁ [mm]	ØD ₃ [mm]	ØD ₄ [mm]	L ₁ [mm]	L ₂ [mm]	L ₃ [mm]	S1 [mm]	S2 [mm]	Ordering Code*	kg/100
	C	CF										
L	315	315	6	4	10	21	14.0	29	12	14	C-AS 06 L X	1.1
			8	6	12	23	16.0	31	14	17	C-AS 08 L X	1.6
			10	8	14	25	18.0	33	17	19	C-AS 10 L X	2.3
			12	10	16	25	18.0	33	19	22	C-AS 12 L X	2.7
			15	12	19	29	22.0	37	22	27	C-AS 15 L X	4.5
			18	15	22	31	23.5	40	27	32	C-AS 18 L X	6.9
	160	160	22	19	27	36	28.5	45	32	36	C-AS 22 L X	10.2
			28	24	32	38	30.5	47	41	41	C-AS 28 L X	16.5
			35	30	40	43	32.5	54	46	50	C-AS 35 L X	24.0
			42	36	46	46	35.0	58	55	60	C-AS 42 L X	33.7
S	630	630	6	4	11	26	19.0	34	14	17	C-AS 06 S X	2.2
			8	5	13	28	21.0	36	17	19	C-AS 08 S X	3.3
			10	7	15	30	22.5	39	19	22	C-AS 10 S X	4.2
			12	8	17	32	24.5	41	22	24	C-AS 12 S X	5.7
			14	10	19	35	27.0	45	24	27	C-AS 14 S X	7.3
			16	12	21	35	26.5	45	27	30	C-AS 16 S X	8.6
	400	400	20	16	26	40	29.5	51	32	36	C-AS 20 S X	13.3
			25	20	31	44	32.0	56	41	46	C-AS 25 S X	22.6
			30	25	36	49	35.5	62	46	50	C-AS 30 S X	30.4
			38	32	44	54	38.0	69	55	60	C-AS 38 S X	46.2
	250	315	38	32	44	54	38.0	69	55	60	C-AS 38 S X	46.2

*Replace the character "C" with "CF" when you require steel!
C = Stainless Steel, 1.4571 **CF** = Galvanized Steel Phosphate Conversion Coating