

C-GR STRAIGHT REDUCER (LL, L)

24° Tube Connection
(DIN EN ISO 8434-1)

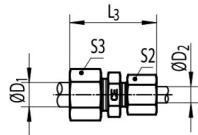

C-GR

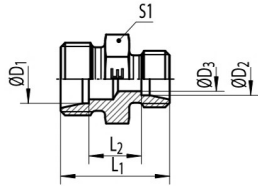

Series	PN [bar]		ØD ₁ [mm]	ØD ₂ [mm]	ØD ₃ [mm]	L ₁ [mm]	L ₂ [mm]	L ₃ [mm]	S1 [mm]	S2 [mm]	S3 [mm]	Ordering Code*	kg/100
	C	CF											
LL	100	100	6	4	3.0	20	10.5	32	11	10	12	C-GR 06/04 LL X	0.7
			8	4	3.0	22	12.5	34	12	10	14	C-GR 08/04 LL X	1.0
			8	6	4.5	22	11.0	34	12	12	14	C-GR 08/06 LL X	1.0
L	315	500	8	6	4.0	25	11.0	41	14	14	17	C-GR 08/06 L X	1.7
			10	6	4.0	26	12.0	42	17	14	19	C-GR 10/06 L X	2.1
			10	8	6.0	26	12.0	42	17	17	19	C-GR 10/08 L X	2.2
			12	6	4.0	27	13.0	43	19	14	22	C-GR 12/06 L X	2.7
			12	8	6.0	27	13.0	43	19	17	22	C-GR 12/08 L X	2.8
			12	10	8.0	28	14.0	44	19	19	22	C-GR 12/10 L X	2.9
	315	400	15	10	8.0	29	15.0	45	24	19	27	C-GR 15/10 L X	4.4
			15	12	10.0	29	15.0	45	24	22	27	C-GR 15/12 L X	4.5
			18	10	8.0	30	15.5	47	27	19	32	C-GR 18/10 L X	6.0
			18	12	10.0	30	15.5	47	27	22	32	C-GR 18/12 L X	6.0
			18	15	12.0	31	16.5	48	27	27	32	C-GR 18/15 L X	6.6
			22	12	10.0	32	17.5	49	32	22	36	C-GR 22/12 L X	7.9
	160	250	22	15	12.0	33	18.5	50	32	27	36	C-GR 22/15 L X	8.5
			22	18	15.0	33	18.0	51	32	32	36	C-GR 22/18 L X	9.0
			28	18	15.0	34	19.0	52	41	32	41	C-GR 28/18 L X	13.5
			28	22	19.0	36	21.0	54	41	36	41	C-GR 28/22 L X	14.0
			35	22	19.0	39	21.0	59	46	36	50	C-GR 35/22 L X	19.8
			35	28	24.0	39	21.0	59	46	41	50	C-GR 35/28 L X	20.1
			42	35	30.0	43	21.5	66	55	50	60	C-GR 42/35 L X	31.2

*Replace the character "C" with "CF" when you require steel!
C = Stainless Steel, 1.4571 CF = Galvanized Steel Cr(VI)-free