

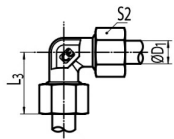

# C-W Connection Studs

Elbow Studs

24° Tube Connection (DIN EN ISO 8434-1)

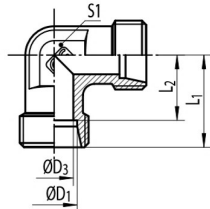

Series	PN [bar]		ØD <sub>1</sub> [mm]	ØD <sub>3</sub> [mm]	L <sub>1</sub> [mm]	L <sub>2</sub> [mm]	L <sub>3</sub> [mm]	S <sub>1</sub> [mm]	S <sub>2</sub> [mm]	Ordering Code *	kg/100	
	C	CF										
LL	100	100	4	3.0	15	11.0	21	9	10	C-W 04 LL X	0.9	
			6	4.5	15	9.5	21	9	12	C-W 06 LL X	0.9	
			8	6.0	17	11.5	23	12	14	C-W 08 LL X	1.5	
			10	8.0	21	15.5	27	12	17	C-W 10 LL X	1.9	
			12	10.0	21	15.0	27	14	19	C-W 12 LL X	2.6	
L	315	500	6	4.0	19	12.0	27	12	14	C-W 06 L X	1.9	
			8	6.0	21	14.0	29	12	17	C-W 08 L X	2.2	
			10	8.0	22	15.0	30	14	19	C-W 10 L X	3.0	
	315	400	12	10.0	24	17.0	32	17	22	C-W 12 L X	4.1	
			15	12.0	28	21.0	36	19	27	C-W 15 L X	7.6	
			18	15.0	31	23.5	40	24	32	C-W 18 L X	10.8	
	160	250	22	19.0	35	27.5	44	27	36	C-W 22 L X	14.6	
			28	24.0	38	30.5	47	36	41	C-W 28 L X	23.9	
			35	30.0	45	34.5	56	41	50	C-W 35 L X	38.8	
	S	630	800	6	4.0	23	16.0	31	12	17	C-W 06 S X	3.3
				8	5.0	24	17.0	32	14	19	C-W 08 S X	4.5
				10	7.0	25	17.5	34	17	22	C-W 10 S X	5.5
630		630	12	8.0	29	21.5	38	17	24	C-W 12 S X	8.1	
			14	10.0	30	22.0	40	19	27	C-W 14 S X	9.6	
400		630	16	12.0	33	24.5	43	24	30	C-W 16 S X	13.6	
			20	16.0	37	26.5	48	27	36	C-W 20 S X	18.8	
400		400	25	20.0	42	30.0	54	36	46	C-W 25 S X	33.7	
			30	25.0	49	35.5	62	41	50	C-W 30 S X	51.5	
250		400	38	32.0	57	41.0	72	50	60	C-W 38 S X	79.7	

\*Replace the character "C" with "CF" when you require steel!  
**C** = Stainless Steel, 1.4571    **CF** = Galvanized Steel Cr(VI)-free